

# MY FEEDER

MADE in ITALY

## CATALOGO RICAMBI/ SYSTEM & SPARE PARTS

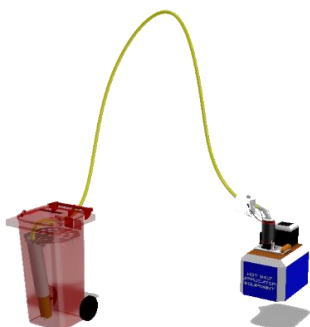

Codice/Code: **MF-VD 1Ch**

Sistema My Feeder, 1 canale, completo di tubo l. 5,0 mt e coperchio fusore a Vs. scelta

My Feeder System, 1 channel, complete of transport tube lenght 5,0m and cover of hot melt system of you choice.

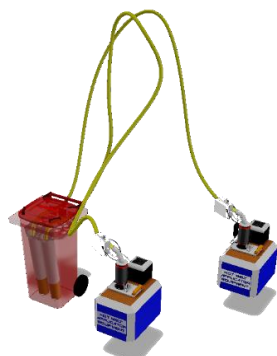

Codice/Code: **MF-VD 2Ch**

Sistema My Feeder, 2 canali, completo di due tubi l. 5,0 mt e due coperchi fusore a Vs. scelta

My Feeder System, 2 channels, complete of two transport tube lenght 5,0m and two covers of hot melt system of you choice.



Codice/Code: **MF-VD KIT**

Da utilizzare come canale aggiuntivo per MyFeeder 1 canale oppure come ricambio per 1 canale completo

For use as an additional channel for MyFeeder 1 channel or as replacement for 1 channel

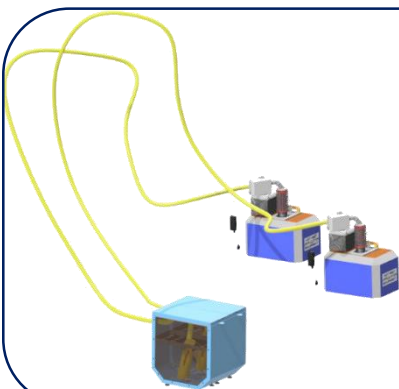

Codice/Code: **MF-VD CUBE**

Sistema My Feeder CUBE, 1 canale, completo di tubo l. 5,0 mt e coperchio fusore a Vs. scelta

My Feeder CUBE System, 1 channel, complete of transport tube lenght 5,0m and cover of hot melt system of you choice.

## COPERCHI VASCHE HOT MELT COVER for HOT MELT SYSTEM

Codice/Code	Descrizione/Description
	<b>NORDSON®</b>
<b>MF-70001</b>	SERIES 3100
<b>MF-70002</b>	SERIES 3400
<b>MF-70003</b>	SERIES 3500
<b>MF-70004</b>	SERIES 3700
<b>MF-70005</b>	Pro blue PB4
<b>MF-70006</b>	Pro blue PB7/PB10
<b>MF-70010</b>	Mesa 4
<b>MF-70011</b>	Mesa 6
<b>MF-70020</b>	DURA BLUE 4
<b>MF-70014</b>	VersaBlue® 12 (V12 V25)

	<b>PREO®</b>
<b>MF-71001</b>	Eclysse
<b>MF-71002</b>	EASY 5

	<b>ROBATECH®</b>
<b>MF-72002</b>	Robatech concept 4
<b>MF-72003</b>	Robatech concept 5
<b>MF-72004</b>	Robatech concept 8

	<b>VALCO-MELTON®</b>
<b>MF-73001</b>	Melton C4
<b>MF-73002</b>	Melton C8
<b>MF-73003</b>	Melton C16
<b>MF-73001-NC</b>	Melton NC4
<b>MF-73004</b>	Melton EC4
<b>MF-73006</b>	Melton D4
<b>MF-73007</b>	Melton EC14 EC 8

	<b>MELER®</b>
<b>MF-74001</b>	Meler ML200
<b>MF74002</b>	Meler Micron 4
<b>MF74003</b>	Meler Micron 8



Per coperchi di dimensioni particolari o fuori standard,  
Inviateci il disegno ed effettueremo una quotazione.

Lids for a particular size or not standard,  
send us the drawing and will be  
made a quotation.

## KIT FILTRO TRAMOGGIA KIT FILTER HOPPER

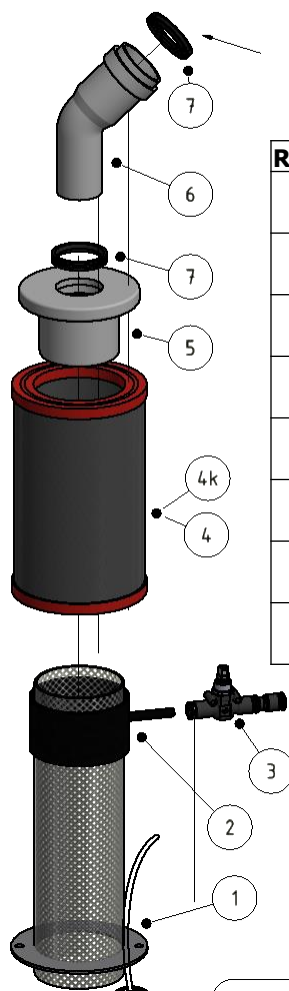

Rif/Ref.	Codice/Code	Descrizione/Description
	<b>MF-60000</b>	Kit Filtro Tramoggia Kit Filter Hopper
<b>1</b>	<b>MF-60001</b>	Tramoggia Hopper
<b>2</b>	<b>MF-60004</b>	Anello Ventilazione Cooling Ring
<b>3</b>	<b>MF-60005</b>	Regolatore di Flusso Flux Air Regulator
<b>4+6</b>	<b>MF-60002 kit</b>	Filtro Tramoggia + Raccordo 45° Hopper Filter + Pipe Fitting 45°
<b>5</b>	<b>MF-60006</b>	Riduzione Tramoggia Hopper Reduction
<b>6</b>	<b>MF-60007</b>	Raccordo 45° Pipe fitting 45°
<b>7</b>	<b>MF-60008</b>	O.ring Raccordo d. 32 O.ring Fitting d. 32



Codice/Code	Descrizione/Description
<b>MF-40003</b>	Tubo di trasporto 3,0m Transport tube 3,0 mt
<b>MF-40005</b>	Tubo di trasporto 5,0m Transport tube 5,0 mt
<b>MF-40010</b>	Tubo di trasporto 10,0m Transport tube 10,0 mt



Codice/Code	Descrizione/Description
<b>MF-10001</b>	Serbatoio 120l ROSSO Tank 120l Red
<b>MF-10002</b>	Serbatoio 120l BLU Tank 120l BLUE
<b>MF-10003</b>	Serbatoio 120l GIALLO Tank 120l YELLOW
<b>MF-10004</b>	Serbatoio 120l VERDE Tank 120l GREEN
<b>MF-10005</b>	Serbatoio 120l BIANCO Tank 120l WHITE



Codice/Code	Descrizione/Description
<b>MF-13100</b>	Griglia Serbatoio 120l Grid Tank 120l
<b>MF-14000</b>	Tubo Guida Guide Tube
<b>MF-15000</b>	Kit passaparete Kit Bulkhead Fitting



Codice/Code	Descrizione/Description
<b>MF-10200</b>	Serbatoio CUBE Tank Cube
<b>MF-10201</b>	Fianco Trasparente (ricambio) Transparent Side (spare parts)
<b>MF-10202</b>	Spugna filtro coperchio CUBE Cover sponge filter
<b>MF-10211</b>	Kit Passaparete CUBE Kit Bulkhead Fitting
<b>MF-10212</b>	Kit Giunzione TANK CUBE Junction kit TANK CUBE



Codice/Code	Descrizione/Description
<b>MF-22001</b>	Lancia Completa Vibro/Desmo Vibro/Dsmo Lance
<b>MF-10210</b>	Kit giunzione lancia CUBE Junction kit lance CUBE



Codice/Code	Descrizione/Description
<b>MF-50000 KIT</b>	Unità di Controllo Completa (unità di controllo+alimentatore+fascette fissaggio+raccordi) Complete Control Board (controllo Board+power supply+fixing calmps+fitting)
<b>MF-50010</b>	Scheda unità di controllo Control unit
<b>MF-50104</b>	SD Card SD Card
<b>MF-50020</b>	Kit parte Pneumatica unità di controllo Pneumatic Kit control board
<b>MF-50100</b>	Alimentatore 220Vac-24VDC / 70W Power Supply 220Vac-24VDC / 70W

<b>MF-50503</b>	Fungo di Emergenza con cavo l. 3,0m Emergency stop with cable 3,0 mt
-----------------	---



<b>MF-62101</b>	Kit Sensore di Livello HT Kit capacitive level sensor HT
-----------------	---



<b>MF-LAMP</b>	Lampada Segnalazione (fissaggio magnetico) Lamp Signal (with magnetic fixing)
----------------	--